

NPT Compression Fittings—Technical Guide

Note: for Reference purposes only

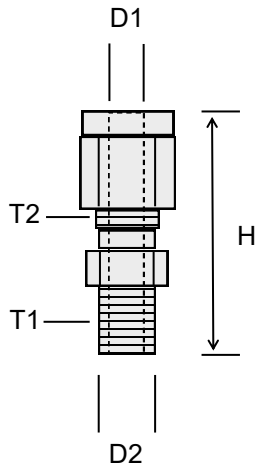

| | T1 | T2 | H | D1 (ID) | D2 (OD) | For Thermocouple Probe Sheath O.D. |
|------------------|----------|---------|-----------------|-----------------|---------------|---------------------------------------|
| CF-0062-18-NPT* | 1/8"-NPT | 10-32 | 1.0" (25 mm) | 0.064" (1.6 mm) | 0.40" (10 mm) | 1/16" |
| CF-0062-14-NPT** | 1/4"-NPT | 10-32 | 1.3" (33 mm) | 0.064" (1.6 mm) | 0.54" (14 mm) | 1/16" |
| CF-0125-18-NPT | 1/8"-NPT | 5/16-20 | 1.2" (30 mm) | 0.135" (3.4 mm) | 0.40" (10 mm) | 1/8" |
| CF-0125-14-NPT | 1/4"-NPT | 5/16-20 | 1.4" (36 mm) | 0.135" (3.4 mm) | 0.54" (14 mm) | 1/8" |
| CF-0187-18-NPT | 1/8"-NPT | 3/8-20 | 1.3" (33 mm) | 0.192" (4.9 mm) | 0.40" (10 mm) | 3/16" |
| CF-0187-14-NPT | 1/4"-NPT | 3/8-20 | 1.4" (36 mm) | 0.192" (4.9 mm) | 0.54" (14 mm) | 3/16" |
| CF-0250-18-NPT | 1/8"-NPT | 7/16-20 | 1.3" (33 mm) | 0.258" (6.5 mm) | 0.40" (10 mm) | 1/4" |
| CF-0250-14-NPT | 1/4"-NPT | 7/16-20 | 1.5" (38 mm) | 0.258" (6.5 mm) | 0.54" (14 mm) | 1/4" |
| CF-0250-12-NPT | 1/2" NPT | 7/16-20 | 1.75" (44.5 mm) | 0.258" (6.5 mm) | .84" (21 mm) | 1/4" |

| | |
|----------------------------|--|
| Material | 316 Stainless Steel |
| Number of Ferrules | 2 (double type) * CF-0062-18-NPT is single type ** CF-0062-14-NPT is single type |
| Pressure Rating (1/8"-NPT) | 6500 PSI (447 bar) |
| Pressure Rating (1/4"-NPT) | 6600 PSI (454 bar) |
| Pressure Rating (1/2"-NPT) | 6600 PSI (454 bar) |

Tightening the fitting

- For 1/16" to 3/16" outer diameter probes turn 3/4 past finger tight
- For 1/4" outer diameter probes turn 1-1/4 past finger tight
- For reassembly after initial installation turn 1/4 past finger tight

Order of Assembly

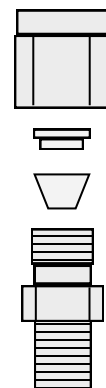

| Thread | Drill | Tap |
|----------|---|--------------|
| 1/8"-NPT | The recommended drill bit size is "R" (.339") or "Q" (.332"). Or, the closest fractional is 11/32 (.342") | 1/8 x 27 NPT |
| 1/4"-NPT | 7/16 (0.438") | 1/4 x 18 NPT |
| 1/2"-NPT | 45/64 (0.703") | 1/2 x 14 NPT |